

STN	Zdravnotechnické armatúry Mechanicky ovládané zmiešavacie batérie (PN 10) Všeobecné technické podmienky	STN EN 817 13 7176
------------	--	--------------------------------------

Sanitary tapware - Mechanical mixing valves (PN 10) - General technical specifications

Táto norma obsahuje anglickú verziu európskej normy.
This standard includes the English version of the European Standard.

Táto norma bola oznámená vo Vestníku ÚNMS SR č. 11/24

Obsahuje: EN 817:2024

Oznámením tejto normy sa ruší
STN EN 817 (13 7176) z januára 2009

139540

Úrad pre normalizáciu, metrológiu a skúšobníctvo Slovenskej republiky, 2024
Slovenská technická norma a technická normalizačná informácia je chránená zákonom č. 60/2018 Z. z. o technickej normalizácii
v znení neskorších predpisov.

EUROPEAN STANDARD

EN 817

NORME EUROPÉENNE

EUROPÄISCHE NORM

September 2024

ICS 91.140.70

Supersedes EN 817:2008

English Version

**Sanitary tapware - Mechanical mixing valves (PN 10) -
General technical specifications**Robinetterie sanitaire - Mitigeurs mécaniques (PN 10)
- Spécifications techniques généralesSanitärarmaturen - Mechanisch einstellbare Mischer
(PN 10) - Allgemeine technische Spezifikation

This European Standard was approved by CEN on 21 July 2024.

CEN members are bound to comply with the CEN/CENELEC Internal Regulations which stipulate the conditions for giving this European Standard the status of a national standard without any alteration. Up-to-date lists and bibliographical references concerning such national standards may be obtained on application to the CEN-CENELEC Management Centre or to any CEN member.

This European Standard exists in three official versions (English, French, German). A version in any other language made by translation under the responsibility of a CEN member into its own language and notified to the CEN-CENELEC Management Centre has the same status as the official versions.

CEN members are the national standards bodies of Austria, Belgium, Bulgaria, Croatia, Cyprus, Czech Republic, Denmark, Estonia, Finland, France, Germany, Greece, Hungary, Iceland, Ireland, Italy, Latvia, Lithuania, Luxembourg, Malta, Netherlands, Norway, Poland, Portugal, Republic of North Macedonia, Romania, Serbia, Slovakia, Slovenia, Spain, Sweden, Switzerland, Türkiye and United Kingdom.

EUROPEAN COMMITTEE FOR STANDARDIZATION
COMITÉ EUROPÉEN DE NORMALISATION
EUROPÄISCHES KOMITEE FÜR NORMUNG**CEN-CENELEC Management Centre: Rue de la Science 23, B-1040 Brussels**

EN 817:2024 (E)

Contents	Page
European foreword	5
Introduction	6
1 Scope	7
2 Normative references	8
3 Terms and definitions	9
4 Designation	11
5 Marking and identification	12
5.1 Marking	12
5.2 Identification	12
6 Materials	13
6.1 Chemical and hygiene requirements	13
6.2 Exposed surface condition and quality of coating	13
7 Backflow protection	13
8 Sequence of testing	13
9 Dimensional characteristics	13
9.1 General remarks	13
9.2 Inlet dimensions	14
9.3 Outlet dimensions	15
9.4 Mounting dimensions	18
9.5 Special cases	19
10 Leaktightness characteristics	19
10.1 Principle	19
10.2 Apparatus	20
10.3 Leaktightness of the obturator and of the tap upstream of the obturator(s) with the obturator in the closed position	20
10.4 Leaktightness downstream of the obturator	20
10.5 Leaktightness of manually operated diverters	21
10.6 Leaktightness and operation of diverters with automatic return (and semi-automatic type diverters)	22
10.7 Cross flow between inlets	23
11 Pressure resistance	24
11.1 Principle	24
11.2 Apparatus	24
11.3 Mechanical behaviour upstream of the obturator – obturator in the closed position	24
11.4 Mechanical behaviour downstream of the obturator – obturator in the open position	25
12 Hydraulic Performance	25
12.1 General	25
12.2 Initial setting	26
12.3 Determination of flow rate	26
12.4 Determination of sensitivity	27

13	Mechanical strength/torsional resistance	29
13.1	Principle.....	29
13.2	Apparatus.....	29
13.3	Procedure.....	29
13.4	Requirements.....	30
14	Mechanical endurance	30
14.1	General	30
14.2	Endurance test of conventional control devices	30
14.3	Endurance test of joystick control devices.....	32
14.4	Endurance test of Single sequential control devices	34
14.5	Endurance test of separate controls	36
14.6	Endurance test of diverter mechanisms	38
14.7	Endurance test for swivel spouts.....	40
15	Acoustic characteristics	41
15.1	General	41
15.2	Procedure.....	42
15.3	Expression of results	42
	Annex A (normative) Apparatus.....	44
A.1	General	44
A.2	Supply circuits	44
A.3	Test circuit	45
A.4	Pressure take off tees.....	47
A.5	Mounting of the mixing valve.....	47
	Annex B (informative) Pressure take-off tee.....	48
	Annex C (informative) Recommended flow rates	51
	Annex D (informative) Product components (detailed by other standards).....	52
	Bibliography	53

Figures

Figure 1	— Supply system of Type 1 with a pressure range of (0,05 to 1,0) MPa [(0,5 to 10) bar].....	8
Figure 2	— single hole taps.....	15
Figure 3	— Multi hole taps.....	15
Figure 4	— Remote outlet.....	16
Figure 5	— Single hole/remote outlet	17
Figure 6	— Bath/shower /remote outlet.....	17
Figure 7	— Single hole taps	19
Figure 8	— Clamping Arrangement for use with ceramic sanitaryware.....	19
Figure 9	— Sensitivity curve	28
Figure 10	— Radius (r) for the determination of sensitivity.....	29
Figure 11	— Rectangular movement (One cycle 0 to 11).....	31
Figure 12	— Test bench adjustment torque for conventional mixing valve.....	32
Figure 13	— Triangular movement (One cycle 0 to 8).....	33
Figure 14	— Test bench adjustment torque for joystick mixing valve.....	34
Figure 15	— linear movement (One cycle 0 to 6)	35
Figure 16	— Test bench adjustment torque for single sequential mixing valve.....	36
Figure A.1	— Supply circuits.....	44

EN 817:2024 (E)

Figure A.2 — Test circuit.....	46
Figure A.3 — Mounting of the mixing valve.....	47
Figure B.1 — Pressure take-off tee (test rig Type 1 taps).....	48
Figure B.2 — Schematic examples of pressure take-off tees (test rig Type 1 taps).....	49

Tables

Table 1 — Conditions of use.....	7
Table 2 — Designation index.....	11
Table 3 — Sequence of testing.....	13
Table 4 — Inlet dimensions sanitary tapware.....	14
Table 5 — Outlet dimensions.....	16
Table 6 — Mounting dimensions<Tbl_-></Tbl_->.....	18
Table 7 — Informative summary of leaktightness tests.....	23
Table 8 — Informative summary of pressure resistance tests.....	25
Table 9 — Initial settings.....	26
Table 10 — Performance levels.....	28
Table 11 — Summary of test conditions for cartridges.....	38
Table 12 — Summary of test conditions for diverters.....	40
Table 13 — Summary of test conditions for swivel spout.....	41
Table 14 — Acoustic group.....	42
Table 15 — Flow rate classes (EN ISO 3822-4:1997, Annex A).....	43
Table A.1 — Connecting dimensions.....	46
Table B.1 — Dimensions of the pressure take-off tee.....	48
Table C.1 — Recommended flow rates.....	51

European foreword

This document (EN 817:2024) has been prepared by Technical Committee CEN/TC 164 “Water supply”, the secretariat of which is held by AFNOR.

This European Standard shall be given the status of a national standard, either by publication of an identical text or by endorsement, at the latest by March 2025, and conflicting national standards shall be withdrawn at the latest by March 2025.

Attention is drawn to the possibility that some of the elements of this document may be the subject of patent rights. CEN shall not be held responsible for identifying any or all such patent rights.

This document supersedes EN 817:2008.

In comparison with the previous edition, the following technical modifications have been made:

- all test of hydraulic performance, acoustic characteristics and leaktightness have been completely revised;
- new endurance test for single sequential control devices has been created;
- figures, tables and dimensions have been revised;
- normative references have been updated.

This document acknowledges the field of application for mechanical mixing valves used in water supply systems of type 1 (see Figure 1 and Table 1) with a pressure range of (0,05 to 1,0) MPa [(0,5 to 10) bar].

Any feedback and questions on this document should be directed to the users’ national standards body. A complete listing of these bodies can be found on the CEN website.

According to the CEN-CENELEC Internal Regulations, the national standards organisations of the following countries are bound to implement this European Standard: Austria, Belgium, Bulgaria, Croatia, Cyprus, Czech Republic, Denmark, Estonia, Finland, France, Germany, Greece, Hungary, Iceland, Ireland, Italy, Latvia, Lithuania, Luxembourg, Malta, Netherlands, Norway, Poland, Portugal, Republic of North Macedonia, Romania, Serbia, Slovakia, Slovenia, Spain, Sweden, Switzerland, Türkiye and the United Kingdom.

EN 817:2024 (E)**Introduction**

In respect of potential adverse effects on the quality of water intended for human consumption caused by the product covered by this document, this document provides no information as to whether the product can be used without restriction in any of the Member States of the EU or EFTA.

NOTE Attention is drawn to existing national regulations that might apply concerning the use and/or the characteristics of these products.

This document identifies characteristics and technical requirements for mechanical mixing valves.

1 Scope

This document specifies:

- a) the field of application for mechanical mixing valves for use in a supply system of Type 1 (see Figure 1);
- b) the dimensional, leaktightness, pressure resistance, hydraulic performance, mechanical strength, endurance, corrosion resistance of the surface of the product, sequence of testing and acoustic characteristics with which sanitary tapware products including their components (flexible hose, pull out spray) need to comply where applicable;
- c) test methods to verify the characteristics.

The tests described in this document are type tests (laboratory tests) and not quality control or factory production control (FPC) tests carried out during manufacture.

This document applies to draw-off taps (mechanical mixing valves) for use with sanitary appliances installed in rooms used for personal hygiene (cloakrooms, bathrooms, etc.) and for food preparation (kitchens), i.e. for use with baths, wash basins, bidets, showers and sinks.

The conditions of use and classifications are given in Table 1.

Table 1 — Conditions of use

Water Supply System	Operating Range of Taps	
	Limits	Recommended ^a
Type 1 see Figure 1	<u>Dynamic Pressure</u> $\geq 0,05 \text{ MPa}$ (0,5 bar) <u>Static Pressure</u> $\leq 1,0 \text{ MPa}$ (10,0 bar)	<u>Dynamic Pressure</u> (0,1 to 0,5) MPa [(1,0 to 5,0) bar]
Temperature	$\leq 70 \text{ }^\circ\text{C}$	$\leq 65 \text{ }^\circ\text{C}$
^a Measured at the point of discharge		

Figure 1 shows a supply system of Type 1 with a pressure range of (0,05 to 1,0) MPa [(0,5 to 10) bar].

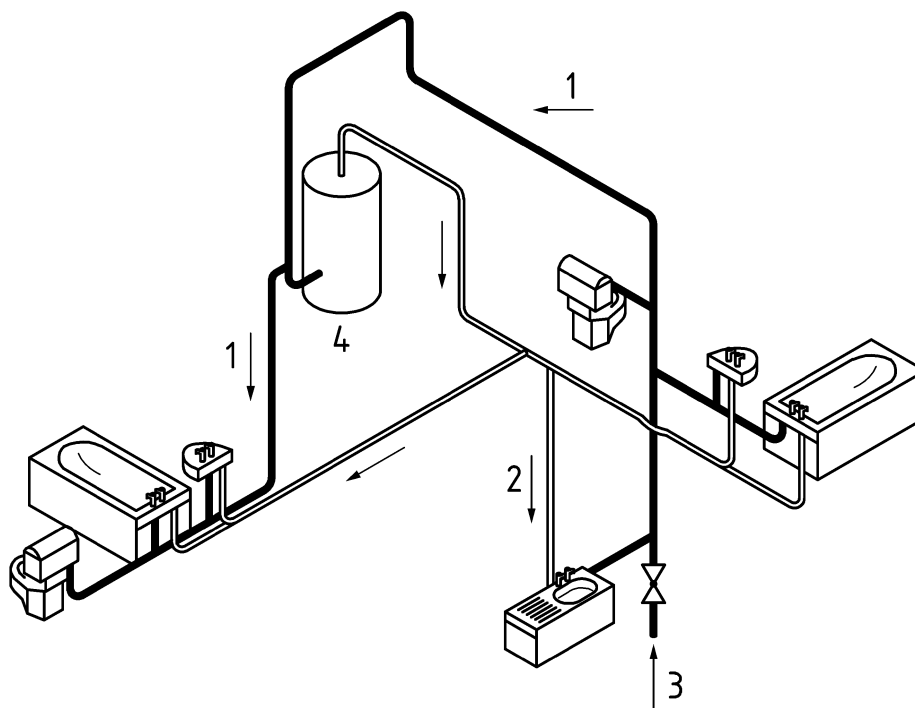
EN 817:2024 (E)**Key**

- 1 cold water
- 2 hot water
- 3 mains supply pipe (Supply pressures up to 10 bar)
- 4 water heater

Figure 1 — Supply system of Type 1 with a pressure range of (0,05 to 1,0) MPa [(0,5 to 10) bar]

Final materials included in the product are not covered by this document.

2 Normative references

The following documents are referred to in the text in such a way that some or all of their content constitutes requirements of this document. For dated references, only the edition cited applies. For undated references, the latest edition of the referenced document (including any amendments) applies.

EN 200, *Sanitary tapware — Single taps and combination taps for water supply systems of type 1 and type 2 — General technical specification*

EN 246, *Sanitary tapware — General specifications for aerators*

EN 248, *Sanitary tapware — General specification for electrodeposited coatings of Ni-Cr*

EN 1057, *Copper and copper alloys — Seamless, round copper tubes for water and gas in sanitary and heating applications*

EN 1717, *Protection against pollution of potable water in water installations and general requirements of devices to prevent pollution by backflow*

EN 13618, *Flexible hose assemblies in drinking water installations — Functional requirements and test methods*

EN 13959, *Anti-pollution check valves — DN 6 to DN 250 inclusive family E, type A, B, C and D*

EN 14506, *Devices to prevent pollution by backflow of potable water — Automatic diverter — Family H, type C*

EN ISO 228-1, *Pipe threads where pressure-tight joints are not made on the threads — Part 1: Dimensions, tolerances and designation (ISO 228-1)*

EN ISO 3822-1, *Acoustics — Laboratory tests on noise emission from appliances and equipment used in water supply installations — Part 1: Method of measurement (ISO 3822-1)*

EN ISO 3822-2, *Acoustics — Laboratory tests on noise emission from appliances and equipment used in water supply installations — Part 2: Mounting and operating conditions for draw-off taps and mixing valves (ISO 3822-2)*

EN ISO 3822-4:1997, *Acoustics — Laboratory tests on noise emission from appliances and equipment used in water supply installations — Part 4: Mounting and operating conditions for special appliances*

koniec náhľadu – text ďalej pokračuje v platenej verzii STN